

Straight Hose Connector

CN-S1-B -G -BLK

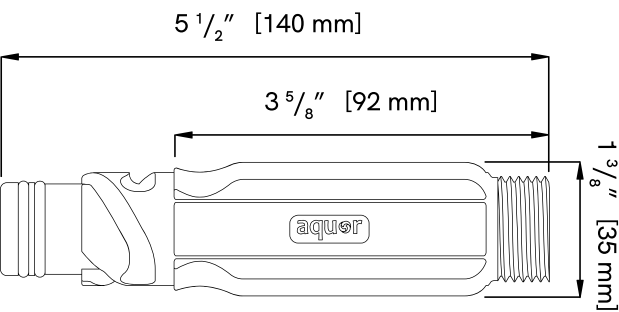

Attach to any garden hose and leave attached for easy water access. Internal one-way valve eliminates sprays or backflow. Connect under full water pressure and easily swap between hoses and nozzles in seconds with a simple push and twist.

- Compatible with all Aquor hydrants
- 3/4" GHT attaches to any garden hose
- Internal check valve to prevent back flow of dirt
- Durable Delrin® polymer and Viton® O-rings

Compatibility	All Aquor hydrants & valves
Colors Available	Aquor Blue, Slate Gray, Jet Black
Outlet	3/4" GHT (m)
Backflow Protection	Yes
Operating Temperature	33-140 °F
Operating Water Pressure	25-125 PSI
Flow Rate	6.8 GPM @ 52 PSI
Connector Material	Acetal Resin Polymer
O-Ring Material	Fluorocarbon Rubber
Warranty	5 Years
SKU	CN-S1-B, CN-S1-G, CN-S1-BLK

Straight Hose Connector

CN-S1-B -G -BLK

Connecting to your Aquor Hydrant

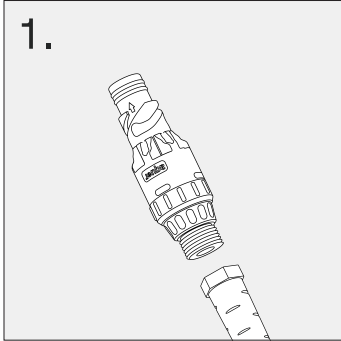

First thread your hose connector onto any hose.

Wide Grip Connector shown for demonstration.

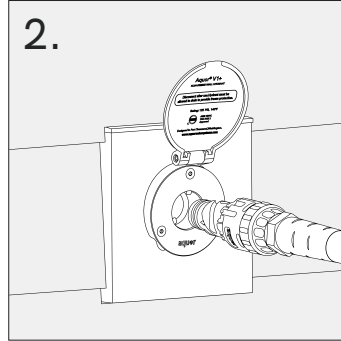

To connect, align the 3 grooves on the connector with the nibs on the hydrant. Gently push in, then twist clockwise.

Wide Grip Connector shown for demonstration.

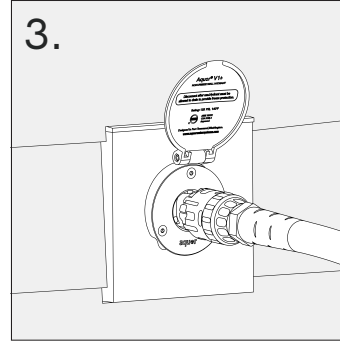

Once you connect, the valve opens and water flow starts instantly.

Wide Grip Connector shown for demonstration.

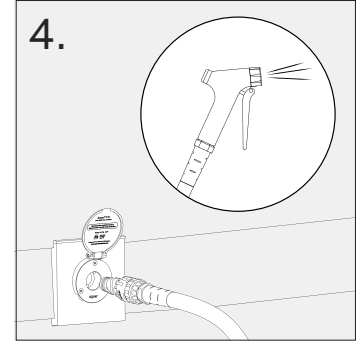

Disconnect and depressurize your hose before storing.

Wide Grip Connector shown for demonstration.